

CERTIFIED RECORD OF LAND CORNER MONUMENTATION

History of original corner establishment:

Original survey by Herman D. Gradon, Contract No. 499, 1884.
Set post 4 ft. long 4 ins. square 24 ins. in ground for corner
to Sec. 20, 21, 28, and 29. From which:

A Pine 14 ins. dia. bears N40°E 39 lks dist. marked
T8S R35E S21 BT

A Pine 8 ins. dia. bears S52°E 47 lks dist. marked
T8S R35E S28 BT.

A Pine 16 ins. dia. bears S78°W 58 lks. dist. marked
T8S R35E S29 BT.

A Pine 10 ins. dia. bears N40°W 14 lks. dist. marked
T8S R35E S20 BT.

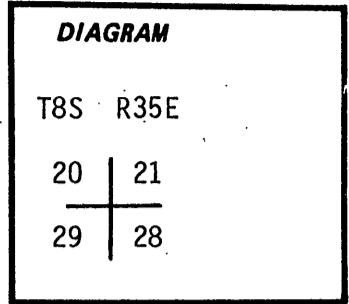

Description of corner evidence found:

A sawn Ponderosa Pine stump 24" dia. with visible scribing not readable
on undercut along side for S21.

A sawn Ponderosa Pine stump 18" dia. with opened blaze and visible scribing
"BT" for S29.

A sawn Ponderosa Pine stump 30" dia. with healed over blaze for S20 BT.

A root hole is only evidence found for Sec 28 BT.

**Description of monument and accessories I established to perpetuate the
original location of this corner:**

At record bearing and dist. from 3 found BT stumps we set 2 1/2"x30"
Galvanized Iron Pipe 22" in ground with mound of stone and dirt to
top of pipe. Pipe has 3" brass cap stamped:

From which:

The original BT's - A Ponderosa Pine stump 24" dia. bears
N40°E 25.7 ft. with visible scribing not readable on undercut.

A Ponderosa Pine stump 30" dia. bears N40°W 9.2 ft. with
healed over blaze.

A Ponderosa Pine stump 18" dia. bears S78°W 38.3 ft. with
visible scribing "BT".

New BT's - A Ponderosa Pine 8" dia. bears N87°E 16.4 ft.
scribed T8S R35E S21 BT.

A Ponderosa Pine 11" dia. bears N 62 1/2°W 60.8 ft. scribed
T8S R35E S20 BT.

A Ponderosa Pine 32" dia. bears S61°W 105.0 ft. scribed
T8S R35E S29 BT.

A Ponderosa Pine 24" dia. bears S2°E 58.5 ft. scribed
T8S R35E S28 BT.

Attached brass washers stamped LS 1099 to foot blaze of
all new BT's.

Corner established and perpetuated in accordance with our
Contract No. 53-04R3-2-01275.

Magnetic Compass. (18° East Declination)

Steel Tape.

Witnesses: Glen Wagoner
Greg Orton
Kevin Sandquist

T8S R35E
S20 S21
S29 S28
PLS 1099
1982

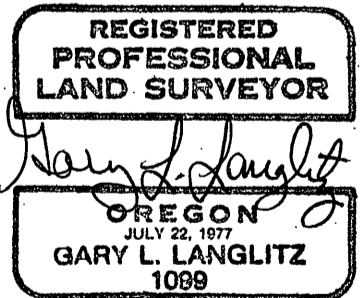

Office of Surveyor County of Grant
State of Oregon hereby certify that the within instrument was filed in this office
for record on the 2 day of Feb, 1983
Robert W. Langlitz by _____
(COUNTY OFFICIAL) (DEPUTY)